

VILA PAULISTA

PLANO DE LOTEAMENTO DA QUADRA - M -

PROPRIETARIO: ACACIO RODRIGUES ANDRADE

ESCALA = 1:1000

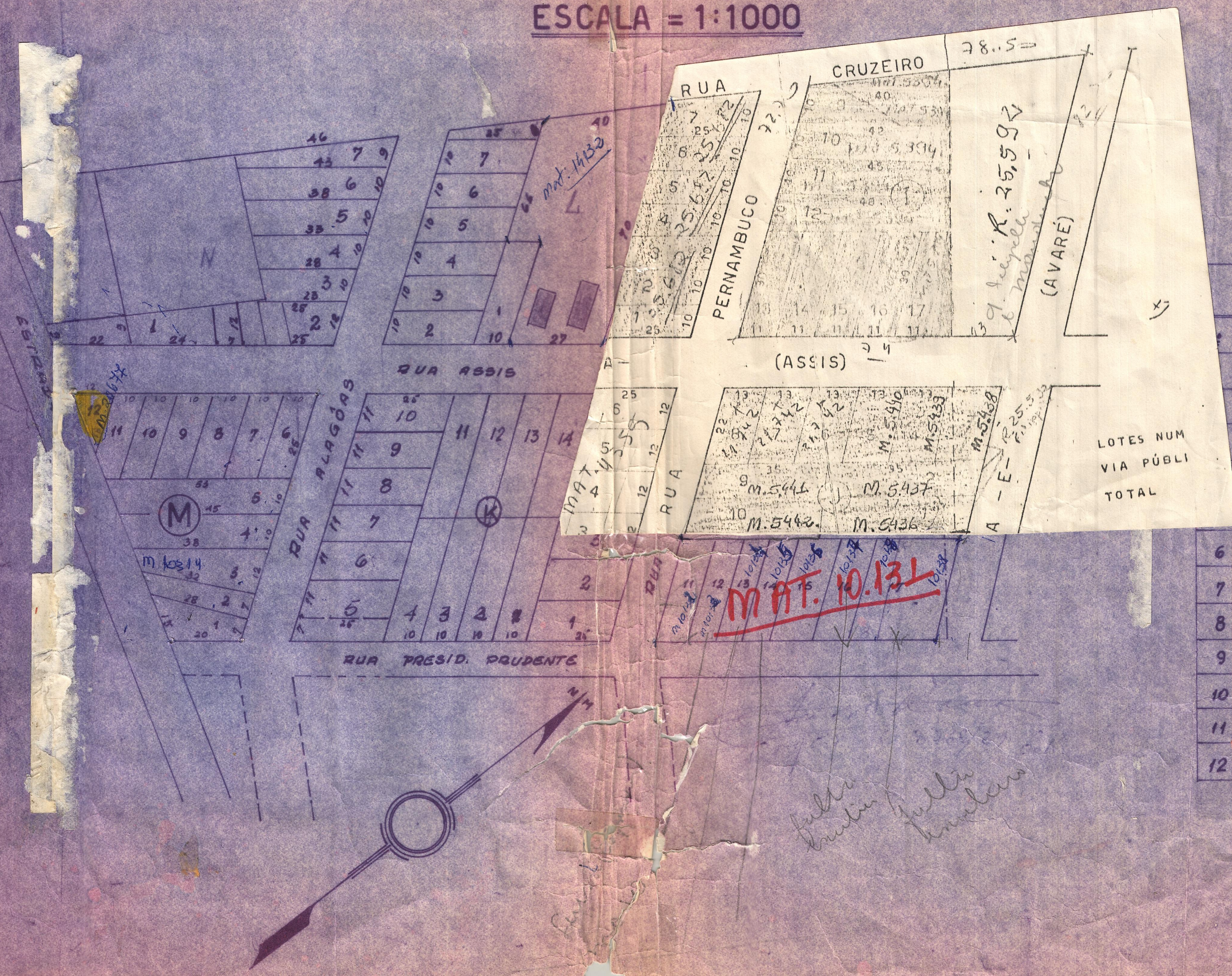

QUADRA - M -		
	DIMENSÕES m	ÁREA
	$\frac{20+28}{2} \times \frac{7+15}{2}$	264 m ²
	$\frac{28+32}{2} \times \frac{7+6}{2}$	195 m ²
	$\frac{32+38}{2} \times \frac{12+6}{2}$	315 m ²
	$\frac{38+45}{2} \times 10$	415 m ²
	$\frac{45+53}{2} \times 10$	490 m ²
6	10 x 25	250 m ²
7	10 x 25	250 m ²
8	10 x 25	250 m ²
9	10 x 25	250 m ²
10	10 x 25	250 m ²
11	10 x 25	250 m ²
12	$\frac{12 \times 18}{2}$	108 m ²
	LOTES NUM VIA PÚBLICA	TOTAL

MAT. 10.131

*fula
bruta
fula
bruta*